

morphy richards®

smart ideas for your home

Ascend Pyramid Kettle

INSTRUCTION MANUAL

Model: MRSGK15B / MRSGK15G / MRSGK15GN

Read these instructions carefully before
using this appliance for the first time.

STORE THESE INSTRUCTIONS CAREFULLY

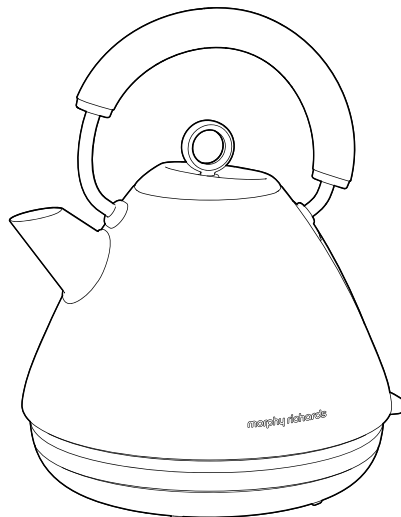

For product hints and tips plus more join us at

www.morphyrichards.com.au

 facebook.com/MorphyRichardsAUS

 instagram.com/morphyrichardsau

SPECIFICATIONS

Model:	MRSKG15B	MRSKG15G	MRSKG15GN
Colour:	Black	Ocean Grey	Bistro Green
Rated Voltage:	220-240V~50-60Hz		
Rated Power:	1850-2200W		
Max Capacity:	1.5L		
External Dimensions (L x W x H):	235 x 277 x 221mm		
Net Weight:	1.42 Kg		

NAMES OF PARTS AND ACCESSORIES

1. Lid
2. Lid knob
3. Spout filter
4. 360°connector
5. Cordless base unit
6. Cord storage
7. On/off switch
8. Power on neon
9. Water level indicator
10. Whistle on/off switch (Depends upon model)

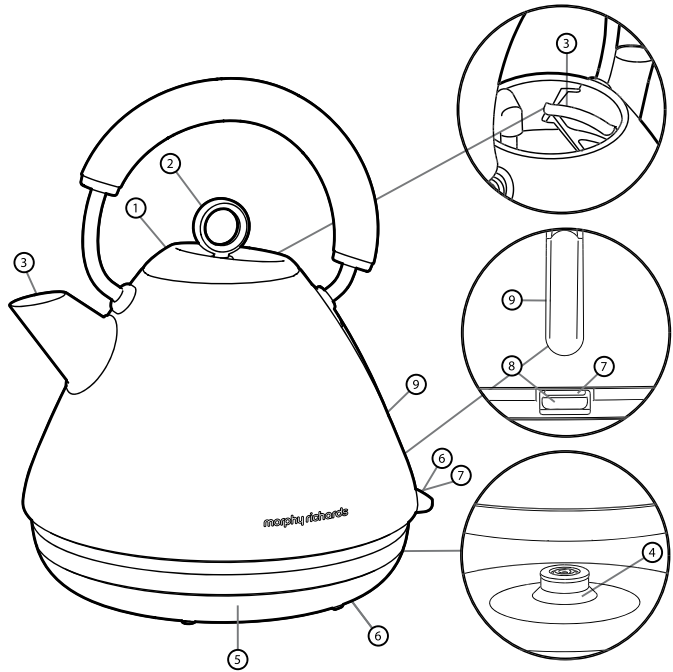
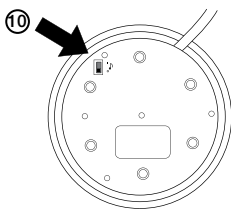

IMPORTANT SAFETY INSTRUCTIONS

The use of any electrical appliance requires the following common sense safety rules.

Please read these instructions carefully before using the product.

- This appliance is not intended for use by persons (including children) with reduced physical, sensory or mental capabilities, or lack of experience and knowledge, unless they have been given supervision or instruction concerning use of the appliance by a person responsible for their safety.
- Children should be supervised to ensure that they do not play with the appliance.
- Cleaning and user maintenance shall not done by children.
- Keep the appliance and its cord out of reach of children.

WARNING: Avoid spillage on the connector.

WARNING: Misuse can lead to injury.

WARNING: Heating element surface is subject to residual heat after use.

WARNING: Do not operate kettle on an inclined plane.

WARNING: Do not move kettle while in use.

Location

- This appliance is intended to be used in household and similar applications such as: farm houses; by clients in hotels, motels and other residential type environments; bed and breakfast type environments. It is not suitable for use in staff kitchen areas in shops, offices and other working environments.
- Always locate your appliance away from the edge of the worktop.
- Ensure that the appliance is used on a firm, flat surface.
- Do not use the appliance outdoors or near water.

WARNING: Do not place the appliance on a metal tray or metal surface while in use.

Mains cable

- Do not let the mains cable hang over the edge of the worktop where a child could reach it.
- Do not let the mains cable run across an open space e.g. between a low socket and a table.
- Do not let the mains cable run across a cooker or other hot area which might damage the cable.
- The mains cable should reach from the socket to the base unit without straining the connections.
- If the mains cable is damaged, it must be replaced by the manufacturer, its service agent or similarly qualified person in order to avoid a hazard.

Personal safety

- **WARNING:** To protect against fire, electric shock and personal injury do not immerse cord, plug and appliance in water or any other liquid.
- Always keep the top of the cordless base dry, especially around the connection area, disconnect the power supply before drying. Allow to dry thoroughly before reconnection to the power supply.
- Do not fill above the MAX mark, otherwise boiling water may be ejected.
- Always pour hot water slowly and carefully without tipping the appliance too fast to prevent splashing and spillage.
- **WARNING:** Do not open the lid whilst the water is boiling.
- Do not hold the switch in the on position or tamper with the switch to fix it in the on position as this may cause damage to the switch-off mechanism.
- Unplug from the outlet before cleaning.
- Allow to cool before putting on or taking off parts and before cleaning.
- Do not move the kettle while switched on.

Other safety considerations

- The use of attachments or tools not recommended or sold by Morphy Richards, may cause fire, electric shock or injury.

- The kettle is only to be used with the stand provided.
- Do not use the appliance for any use other than to boil water.
- Do not place the appliance on or near a hot gas or electric burner or in a heated oven.
- The appliance must not be on the base unit when being filled with water.
- Unplug from the outlet when not in use.
- **WARNING:** The appliance must not be immersed for cleaning.
- **CAUTION:** To prevent damage to the appliance, do not use alkaline cleaning agents when cleaning. Use a soft cloth and detergent.

Electrical requirements

- Check that the voltage on the rating plate of your appliance corresponds with your house electricity supply which must be A.C. (Alternating Current).
- **WARNING:** This appliance must be earthed.

FILLING THE KETTLE

1. Wherever possible fill through the spout, as this helps to free the filter from limescale build-up. The integrated water level indicator allows you to easily see the amount of water in the kettle. Always ensure that the level of water in the kettle is filled to at least the minimum level shown on the water gauge.
2. Place the kettle on the base unit, ensuring the kettle locates on to the 360° connector. The 360° connector allows the kettle to be located at any position. Ideal for left and right handed users and for convenient positioning on the worktop.
3. Plug in and switch on at the wall socket.
4. Switch the kettle on. The 'power on' light will illuminate.
5. Fast boil kettles perform differently, if your kettle is a fast boil model, it may sound louder during boiling, and switch off suddenly with no after noise - this is normal.
6. When the water boils the kettle will switch off automatically. If you are using the kettle for the first time, pour away the boiled water and refill.

7. Lift the kettle from the base unit by the handle ensuring you hold the kettle level. To re-boil, switch ON again. If the kettle has just switched off wait a minute or two before switching it back on again. If you do not put in enough water, or switch on the kettle when it is empty, the safety cut-out will switch off the power automatically. If this happens, refill and wait a few minutes for the element to cool, then use as normal.

WHISTLE FEATURE

There is a switch on the cordless base of the product that can switch the whistle on and off as desired. Refer to page 2.

FILTER REMOVAL

1. Open the lid.
2. Lift the filter upwards from its holder.
3. To refit the filter, slide it into the side wall guides of the filter holder until it clicks into place.

WARNING: Unless the filter is fitted correctly, the kettle lid may not close and lock securely.

DESCALING

IMPORTANT: As this kettle is fitted with a concealed element it must be descaled regularly. The frequency of descaling depends on usage and the hardness of the water in your area.

Excessive scale can cause the kettle to switch off before boiling and may damage the element invalidating the warranty.

It is essential that regular descaling takes place.

Remove hard scale using a proprietary descaling product suitable for stainless steel kettles.

Alternatively use citric acid crystals (available from most pharmacies) as follows.

1. Fill the kettle 3/4 full, boil, then unplug the kettle (remove the cordless kettle from the base unit) and stand it in an empty sink or bowl.
2. Add 50gm of citric acid crystals to the water gradually, then leave the kettle to stand. Do not use a more concentrated solution.
3. As soon as the effervescence subsides, empty the kettle and rinse it thoroughly with cold water.
4. Wipe the outside of the kettle thoroughly with a damp cloth to remove all traces of acid which may damage the finish.

IMPORTANT: Ensure that the electrical connections are completely dry before using the kettle.

CLEANING

WARNING: Always disconnect the plug from the mains and allow the kettle to cool before cleaning.

CAUTION: To prevent damage to the appliance do not use alkaline cleaning agents when cleaning, use a soft cloth and a mild detergent.

Wipe the outside with a damp cloth.

IMPORTANT: Do not use abrasive cleaners on the outside of the kettle which may scratch the surface.

WARRANTY

Please refer to the warranty card in the box for warranty information. For any troubleshooting advice, please contact the relative Customer Care Centre below.

Glen Dimplex Australia Pty Ltd
8 Lakeview Drive,
Scoresby 3179, Victoria
Australia
Ph: 1300 556 816

Glen Dimplex New Zealand Ltd
38 Harris Road, East Tamaki,
Auckland 2013
New Zealand
Ph: 0800 666 2824



Recycling: Do not dispose of electrical appliances as unsorted municipal waste. Use separate collection facilities. Contact your local government for information regarding the collection systems available. If electrical appliances are disposed of in landfills or dumps, hazardous substances can leak into the ground water, polluting the food chain and damaging health and wellbeing.

morphyrichards®

Glen Dimplex Australia Pty Ltd
8 Lakeview Drive
Scoresby VIC 3179
Phone: 1300 556 816
Email: sales@glendimplex.com.au
Web: www.morphyrichards.com.au

© Glen Dimplex Australia. All rights reserved. Material contained in this publication may not be reproduced in whole or in part, without prior permission in writing of Glen Dimplex Australia.

MRSKG15_IM_v3