

morphy richards®

smart ideas for your home

Auto Rice Dispenser

INSTRUCTION MANUAL

Model: MRRB12W

Read these instructions carefully before
using this appliance for the first time.

STORE THESE INSTRUCTIONS CAREFULLY

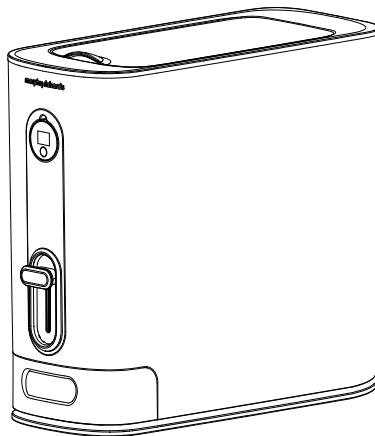

For product hints and tips plus more join us at

www.morphyrichards.com.au



facebook.com/MorphyRichardsAUS



instagram.com/morphyrichardsau

IMPORTANT SAFETY INSTRUCTIONS

- Before using this product, please read this manual carefully.
- This product is intended for domestic use.
- This product should not be placed on or beside high temperature gas or electric stoves.
- Discarded electrical products and devices should be taken to a recycling station.
- This product should only be used for storing rice, cereals and other food.
- Do not use abrasive cleaning items to wipe the product surface.
- Use warm water, neutral detergent and wipe with a clean cloth.
- Children should be supervised to ensure that they do not play with the appliance.
- Appliances can not be used by persons with reduced physical, sensory or mental capabilities or lack of experience and knowledge if they have been given supervision or instruction concerning use of the appliance in a safe way.
- In the absence of supervision, the cleaning and maintenance work should not be done by children.
- Do not use this product if any parts are missing or damaged.
- Do not attempt to repair or adjust any mechanical functions of this appliance. If the appliance is damaged, please contact the Customer Care Centre number located at the end of this manual.
- This appliance must not be immersed in water or other liquids.
- Do not disassemble, squeeze, puncture or submerge the product in water.

IMPORTANT SAFETY INSTRUCTIONS

- Do not keep this appliance in an environment with a temperature higher than 60 °C.
- This product is suitable for home use, do not use it for other purposes.
- Do not put any part of this product into a dishwasher, microwave oven, disinfection cabinet or hot water over 60 °C for cleaning or disinfection. Do not use other equipment for heating to avoid deformation or damage of parts.
- Please use a clean and soft wet cloth to wipe the inner barrel, rice outlet tray, moisture drying box and the surface of the product evenly, and then dry it with a dry cloth.
- Do not use toxic cleaning solutions to clean this appliance.

WARNING: KEEP BATTERIES OUT OF REACH OF CHILDREN

- This appliance contains a 3V button battery. Swallowing may lead to serious injury or death in as little as 2 hours due to chemical burns or perforation of the oesophagus.
- If you suspect a child has swallowed or inserted a button battery, immediately call the 24 hour Poisons Information Centre on 13 11 26 (Australia) or 0800 764 766 (New Zealand) for fast, expert advice.
- Examine devices and make sure the battery compartment is correctly secured, e.g. that the screw or other fastener is tightened. Do not use if the compartment is not secure.
- Dispose of used button batteries immediately and safely. Flat batteries can still be dangerous.



INTRODUCTION

Thank you for purchasing a Morphy Richards Auto Rice Dispenser. Please take some time to familiarise yourself with your new appliance. This manual explains what you need to do before first use as well as explaining some hints and tips to keep your product operating correctly.

READ CAREFULLY AND KEEP FOR FUTURE REFERENCE

SPECIFICATIONS

Model:	MRRB12W
Colour:	White
Construction Material:	ABS & PP Plastic
Timer Battery Rated Voltage:	3V
Timer Battery Lifespan:	2 years
Timer Memory:	21 days
Maximum Capacity:	12kg
Product Dimensions (L x W x H):	397 x 185 x 430mm
Net Weight:	4.15kg

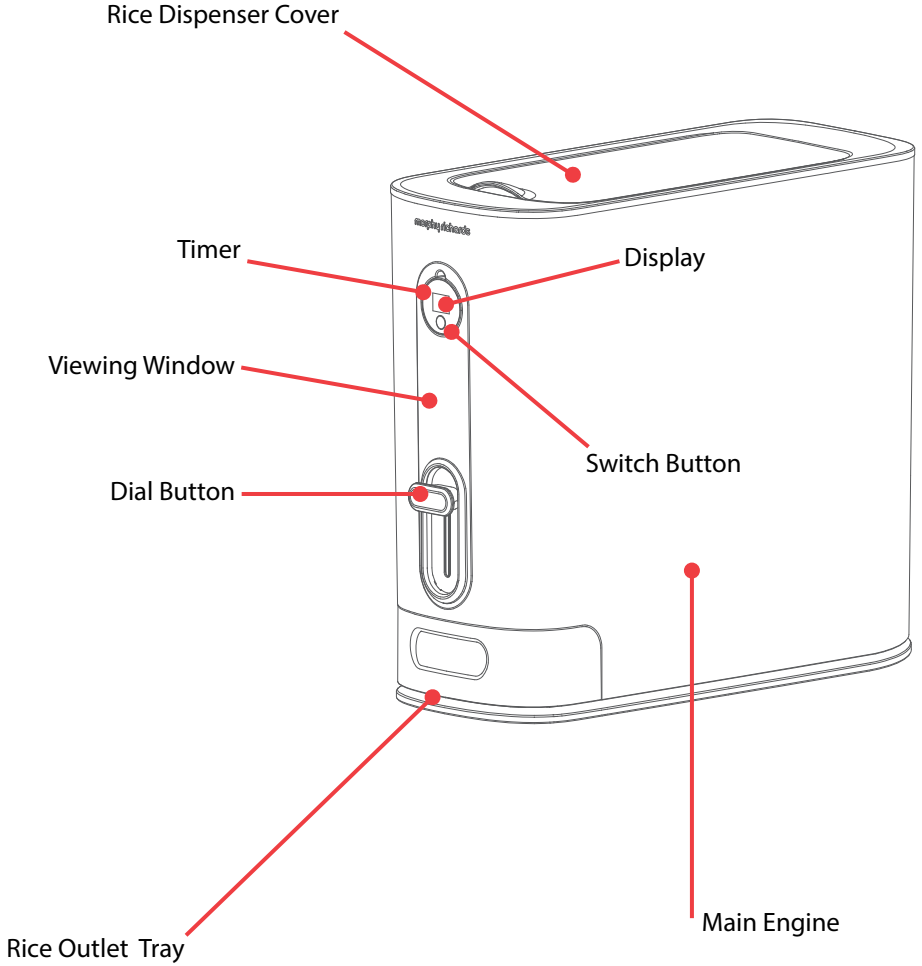

OPERATING INSTRUCTIONS

Before first use, please take a few minutes to read this manual and find a place to keep it handy for future reference. Please pay particular attention to the safety instructions.

1. Unpack the appliance and check that all items are included.
2. Remove the rice dispenser cover and pour rice into the cavity (the maximum capacity of this product is 12kg). Close the rice dispenser cover.

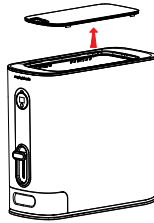

3. When the appliance leaves the factory, it is in an off state. Press the switch button to start the machine and it will start to calculate the days. The first power on starts from 01 days, and the timer records each day. When it reaches 21, the timer sounds three times, and the display starts to flash. Until the user presses the switch button, (long press for two seconds) the timer will reset. If the number of days is not reset, the display continues to flash and will continue to record the number of days.
4. Press the dial button down. After releasing the button, the dial button will rebound automatically, and approximately 150g rice (1-2 cups) will drop into the rice outlet tray.

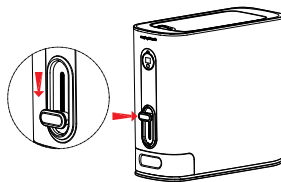

5. Remove the rice outlet tray.

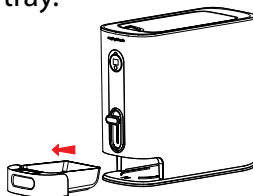

WARNING: When the rice outlet tray is not in the appliance, the dial button is in a locked position, and rice can not be dispensed. Do not press the dial button with excessive force.

BATTERY REPLACEMENT

1. Use a tool to remove the timer from the circular groove as shown in the diagram.

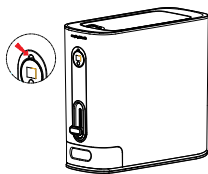

2. Remove the timer.

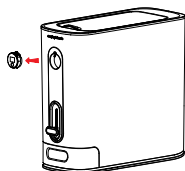

3. Release the safety clip of the timer button and lift upwards to remove the rear cover.
4. Remove the 3V button battery and replace with a new battery.
5. Replace the rear cover, which should be aligned with the two holes of the timer cover and close the cover.

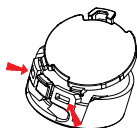

6. The timer is installed in the viewing window, ensure the button is installed facing down.

WARNING: This appliance contains a 3V button battery. Keep batteries out of the reach of children. If you suspect a child has swallowed a button battery, immediately call the 24 hour Poisons Information Centre on 13 11 26 (Australia) or 0800 764 766 (New Zealand) for fast, expert advice.



MOISTURE DRYING BOX

This appliance is supplied with a drying box, which is food grade material and can have herbs or drying agents added to remove moisture and prevent insects from your rice supply.

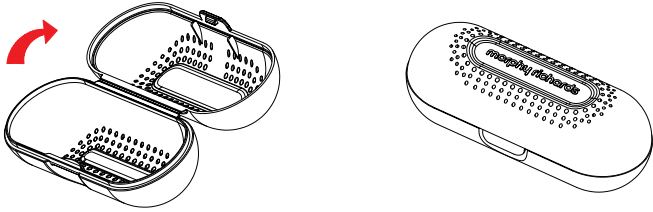

Open the drying box and add edible moisture and insect proof items. Close the drying box and put into the rice dispenser.

MAINTENANCE

If the unit fails to operate efficiently, is broken or other problems arise, do not operate.

Ask for advice by calling your local after sales service agent or the Customer Care Centre on 1300 556 816 (AU) / 0800 666 2824 (NZ).

WARRANTY

Please refer to the warranty card in the box for warranty information. For any troubleshooting advice, please contact the relative Customer Care Centre below.

Glen Dimplex Australia Pty Ltd
8 Lakeview Drive,
Scoresby 3179, Victoria
Australia
Ph: 1300 556 816

Glen Dimplex New Zealand Ltd
38 Harris Road, East Tamaki,
Auckland 2013
New Zealand
Ph: 0800 666 2824



Recycling: Do not dispose of electrical appliances as unsorted municipal waste. Use separate collection facilities. Contact your local government for information regarding the collection systems available. If electrical appliances are disposed of in landfills or dumps, hazardous substances can leak into the ground water, polluting the food chain and damaging health and wellbeing.

morphy richards®

Glen Dimplex Australia Pty Ltd
8 Lakeview Drive
Scoresby VIC 3179
Phone: 1300 556 816
Email: sales@glendimplex.com.au
Web: www.morphyrichards.com.au

© Glen Dimplex Australia. All rights reserved. Material contained in this publication may not be reproduced in whole or in part, without prior permission in writing of Glen Dimplex Australia.

MRRB12W-IB REV1